

INVICTUS CENTRE

Where Holistic Healing Begins



Client: Defence Headquarters, Nigeria
Designed by: Kobina Banning

ABOUT

Proposed Centre for Rehabilitation and Reintegration of Wounded, Injured and Sick [**WIS**]
Project Location: **Giri, Abuja**



Nestled in the serene landscapes of Giri, Abuja, the **Invictus Centre** emerges as a groundbreaking institution, the first of its kind in Africa, dedicated to the rehabilitation and reintegration of wounded, injured, and sick (WIS)

soldiers. The design of the Invictus Centre draws inspiration from the rich architectural heritage of Nigerian culture, embodying the timeless beauty of a garden city that fosters a deep sense of nature, community, and openness.

Here, amidst the harmonious blend of traditional forms and modern innovation, soldiers embark on a transformative journey of healing, hope, and renewal.

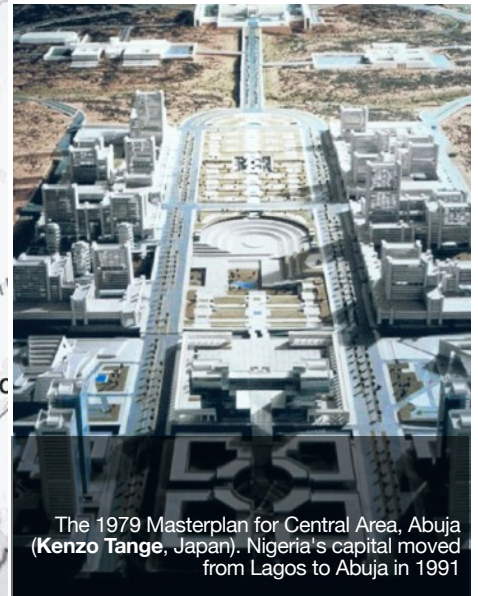
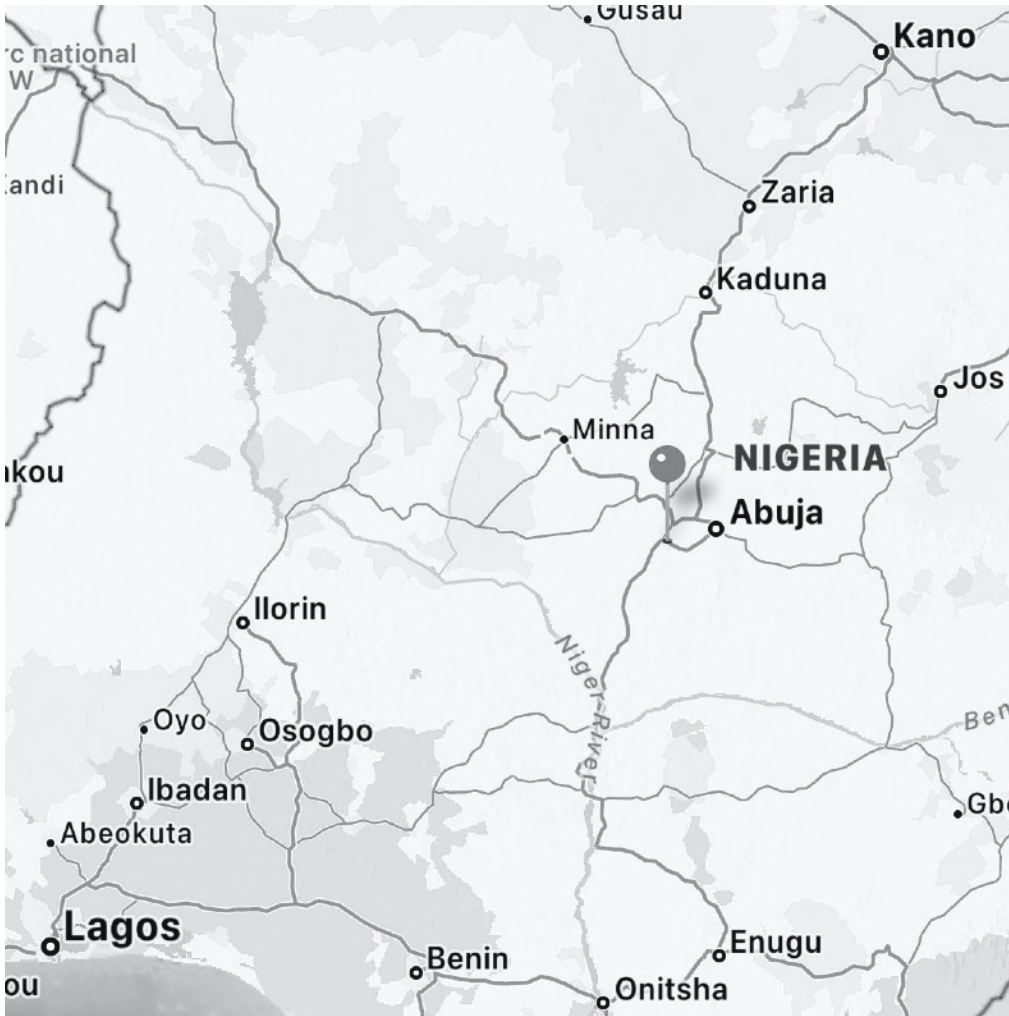

The 1979 Masterplan for Central Area, Abuja (Kenzo Tange, Japan). Nigeria's capital moved from Lagos to Abuja in 1991



Duke of Sussex Prince Harry with the Chief of Defence Staff General Christopher Musa, Nigeria (12/05/2024)

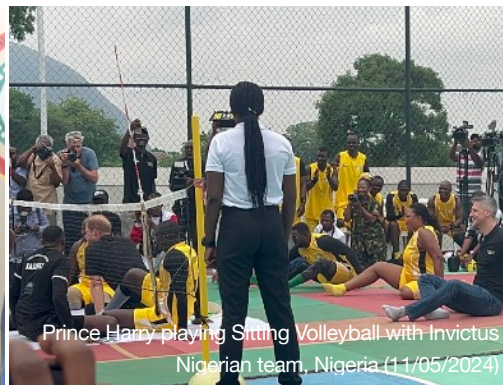

Prince Harry playing Sitting Volleyball with Invictus Nigerian team, Nigeria (11/05/2024)



Abuja City Gate, Nigeria (11/05/2024)

THE DREAM

Abuja: 'the City- Beautiful'

Design Philosophy

The design philosophy of the Invictus Centre embraces the rich cultural heritage of Nigeria, integrating traditional architectural forms with modern innovations. The concept of a garden city is central to the design, fostering a deep connection with nature and creating an environment conducive to healing and community building. The strategic placement of green spaces, gardens, and

communal areas promotes mental and physical well-being, offering a holistic approach to rehabilitation and reintegration.

Family Integration and Community Support

As soldiers and their families navigate the healing journey, the open courtyards of The Invictus Centre serve as sanctuaries of peace and reflection. Linear paths, meandering walkways, and designated points for social interaction weave through

the compound, encouraging spontaneous encounters and fostering a sense of community. Entrances to each structure are strategically placed within the courtyards, guiding pedestrians into settings where chance social interactions can flourish. From group activities to meditation spaces, indoor and outdoor gyms, lush gardens, every corner of the path beckons with the promise of connection, camaraderie, and renewal



Duke of Sussex Prince Harry with the Chief of Defence Staff, General Christopher Musa, Nigeria (12/05/2024)



Duke and Duchess of Sussex visit the Defence Headquarters, Nigeria (12/05/2024)



Duke and Duchess of Sussex Visit Lagos State Governor's office Nigeria (12/05/2024)



Duke of Sussex Prince Harry and CDS General Christopher Musa at the Defense Headquarters, Nigeria (11/05/2024)



Duke of Sussex Prince Harry visits wounded soldiers at the 44 Army Reference Hospital at Kaduna, Nigeria (12/05/2024)



AVM Timothy Marquis with the Duke of Sussex visiting wounded soldiers at the 44 Army Reference Hospital at Kaduna, Nigeria Kaduna, Nigeria (12/05/2024)

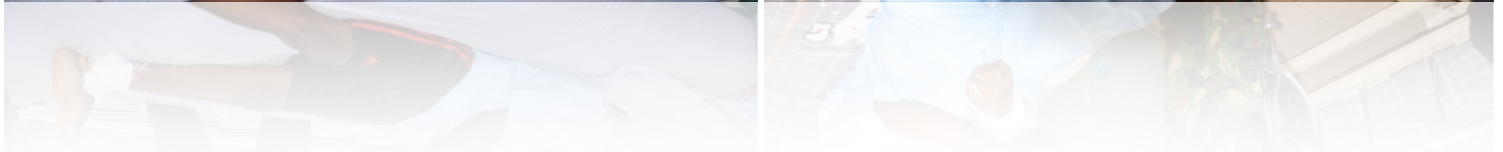

JOURNEY OF HOPE

Invitation of **The Duke and Duchess of Sussex** to Nigeria by Nigeria's Chief of Defense staff **General Christopher Musa**





Duke and Duchess of Sussex at the Lagos Polo club Charity Cup event, Nigeria (12/05/2024)



CDS General Christopher Musa with the Invictus Nigeria Members, Lagos Nigeria (11/05/2024)



Nigerian Veterans at the Defense Headquarters, Nigeria (11/05/2024)



Duke and Duchess of Sussex arrive in Lagos Welcoming performance (12/05/2024)



Duke of Sussex and Architect Kobina Banning, Abuja (12/05/2024)



Nigerian Army Veterans with Architect Banning at the Defense Headquarters, Nigeria (11/05/2024)

SUPPORT HIGHLIGHTS

Hopes and Dreams coming Alive





Invictus Games Team Nigeria

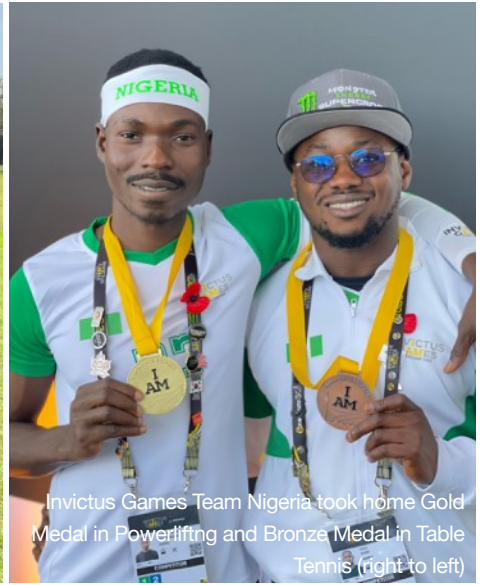

Invictus Games Team Nigeria took home Gold Medal in Powerlifting and Bronze Medal in Table Tennis (right to left)



Dean and Peacemaker at the Winter Germany Invictus Events 2023



Table Tennis Game among Invictus Nigerian team members



Duke and Duchess of Sussex at the Invictus Games in Dusseldorf (BBC 18/09/2023)

THE SPIRIT OF INVICTUS

Team Nigeria Representing Globally



Archery



Powerlifting

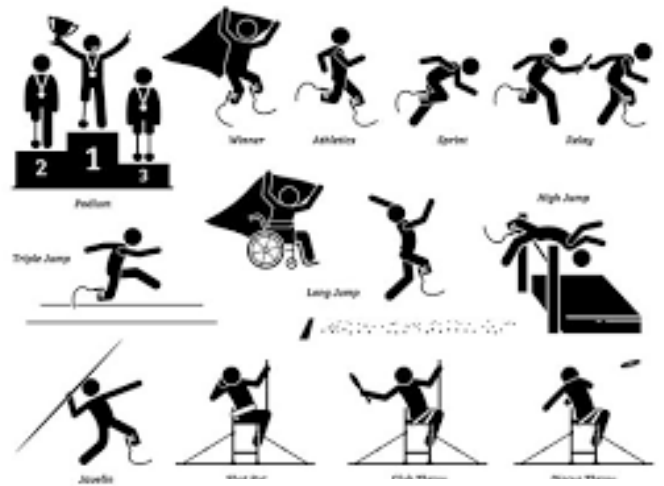

Track and Field



Sitting Volley



Indoor Rowing



Wheelchair Basket ball



Wheelchair Rugby



Road cycling



Wheelchair Tennis

ACTIVITIES

Purposeful Healing through Sports

The Invictus Centre will include a sports complex attached to the clinic which is key to the recovery of the WIS. This will enable them take part in adaptive sports such as:

- Seated volleyball
- Wheelchair basketball
- Rowing
- Swimming
- Powerlifting
- Wheelchair Rugby
- Archery
- Track and Field
- Cycling
- Table tennis

These sports help the WIS recover quicker and also bring confidence to newly wounded soldiers who come to the hospital for the first time



INCLUSIVE THERAPY

Engaging all Senses





LOCAL ART + CRAFT

Heritage + Cultural

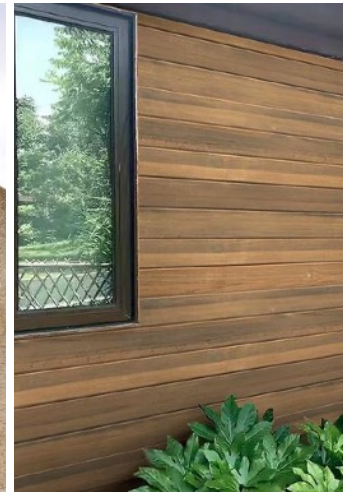

TRUTH IN MATERIALS

Earthy and Regional





AFFIRMATIONS

Entry Walk Pavilion





1: 500

Legend

- 1 Entrance/ Security Gate house Parking Area
- 2 Storage & Vehicle Maintenance
- 3 Entry Walkway Pavilion
- 4 Garden of Hope
- 5 Drop off
- 6 Administration & Clinic
- 7 Family Housing
- 8 Children's Play Area
- 9 Mental Wellness, Prayer & Meditation Block
- 10 Residential: 1 & 2 Bedroom Apartments
- 11 Peace Pond with Bridge
- 12 Pond Viewing Deck
- 13 Basket Ball Court
- 14 Female Ward
- 15 Male Ward
- 16 Indoor/ Outdoor Gym
- 17 Indoor Pool
- 18 Healing Walkway Spine
- 19 Healing Garden Pockets
- 20 Staff Accommodation
- 21 Track & Field Sports
- 22 Spectator Pavilion
- 23 Long Tennis Court
- 24 Volleyball Court
- 25 Cheering Platform
- 26 Archery Range
- 27 Riverwalk Pavilion
- 28 Peace Farm
- 29 Farm Barn
- 30 Theatre
- 31 Peace Garden
- 32 Lilypads

LAYOUT

What's Where?



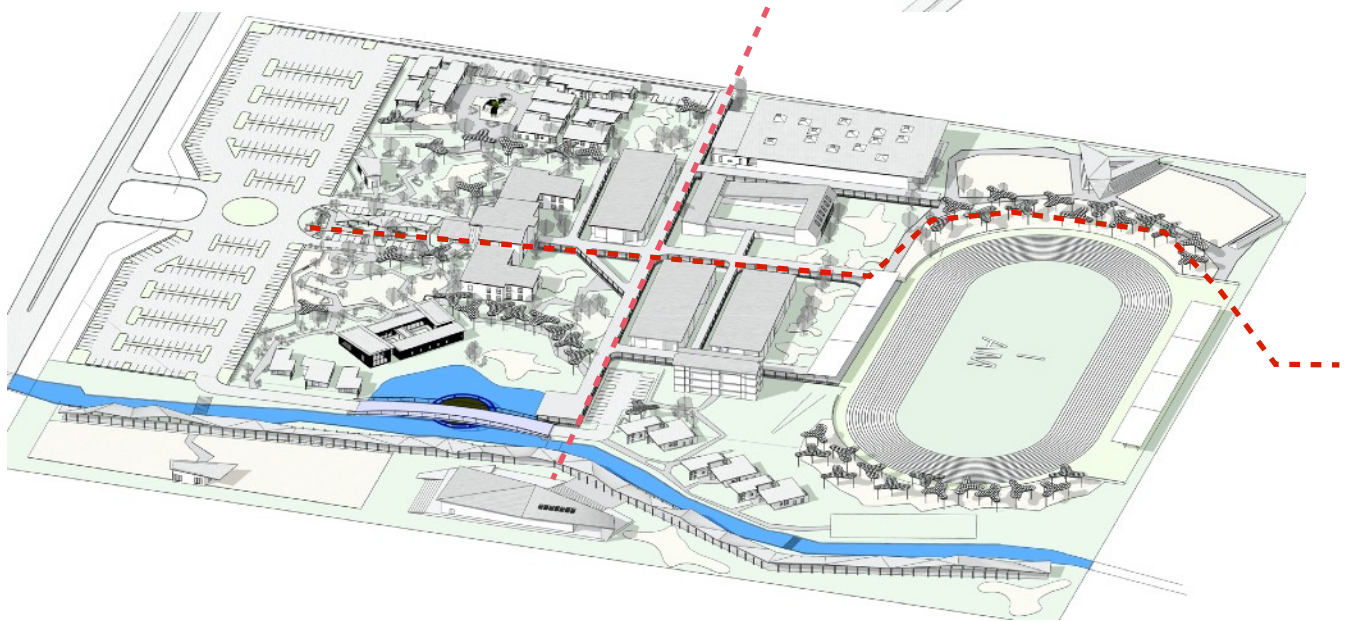
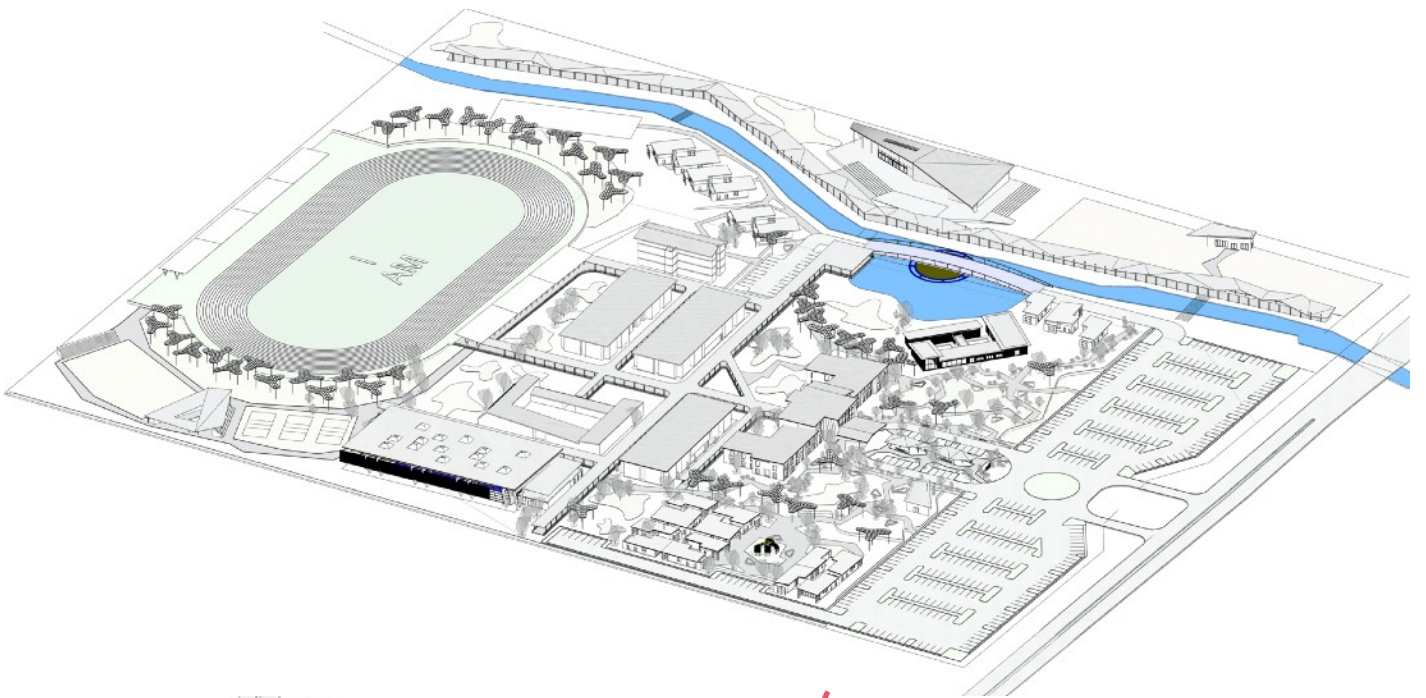

AXONOMETRIC

Long Views



Front View



Back View

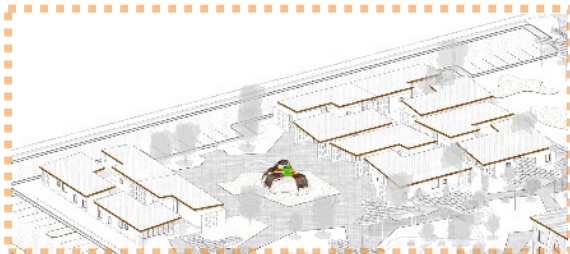
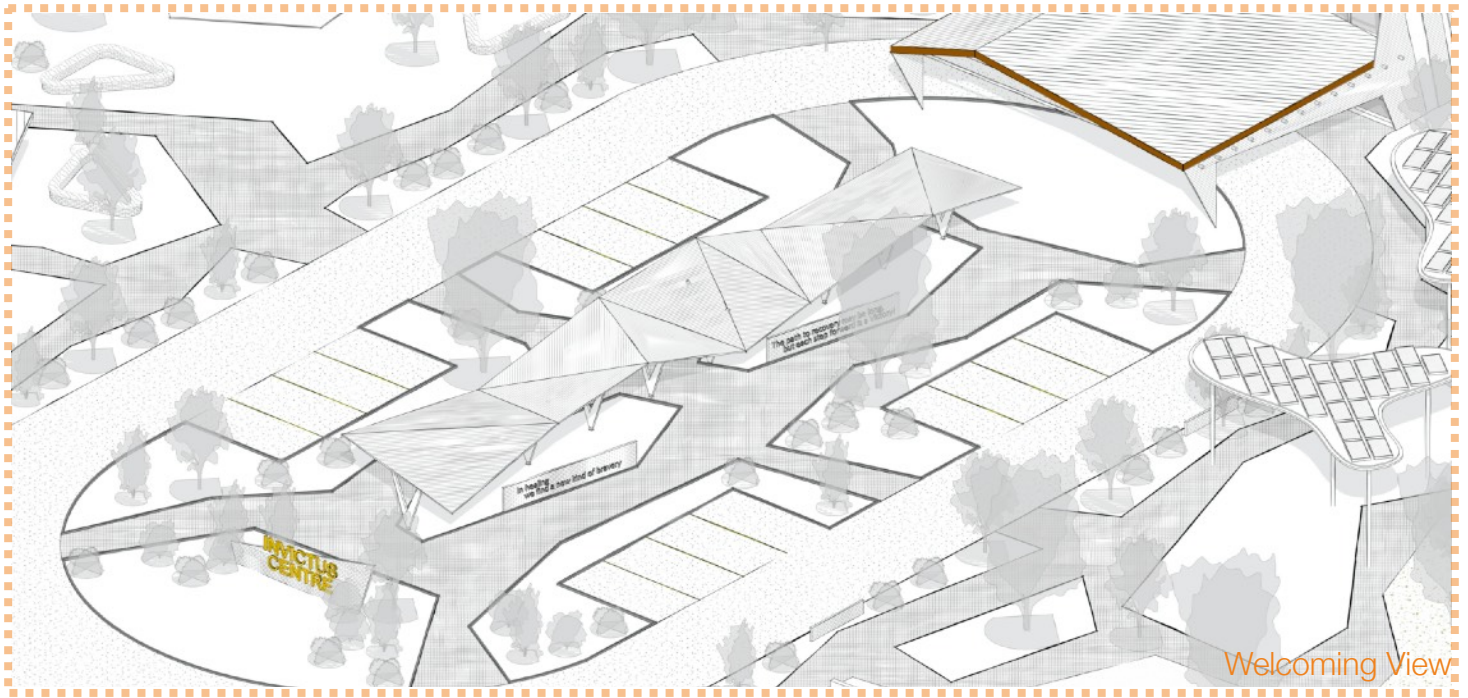

Family Housing and Kid's Play

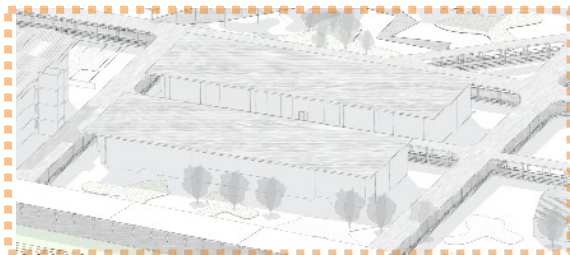

Wards

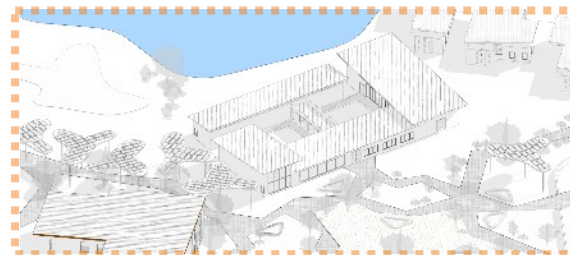

Wellness and Therapeutic Garden

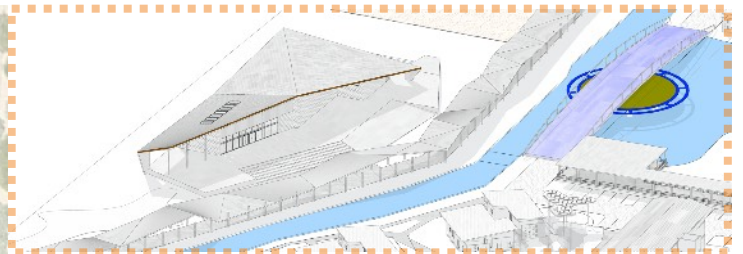

Theatre and Bridge

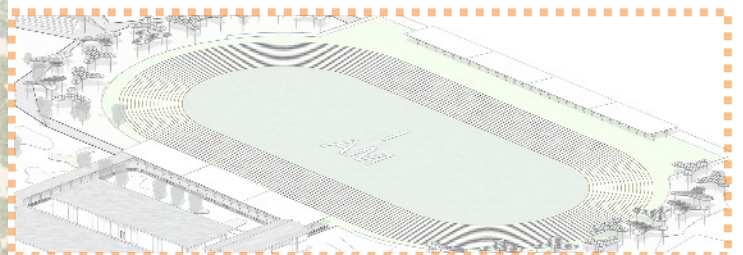

Track and Field

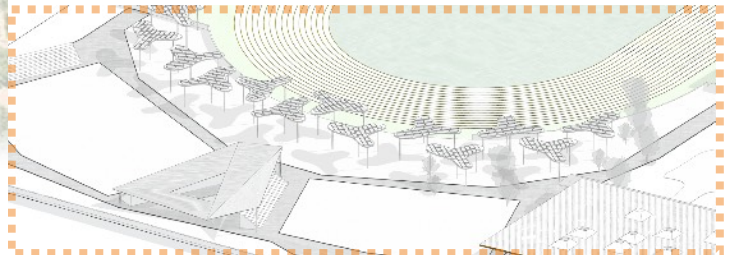

Sports and Court

AXONOMETRIC

How does the Jigsaw fit?

1

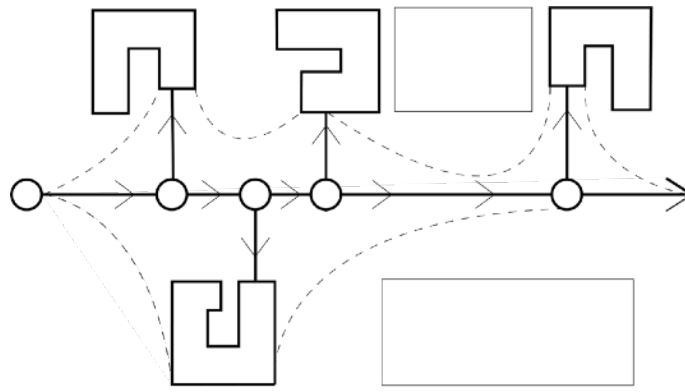

2

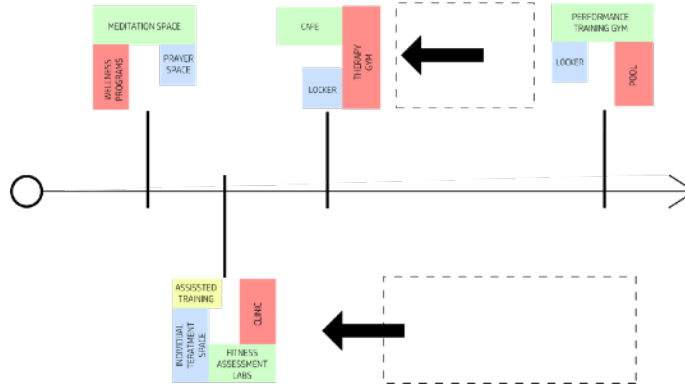

3

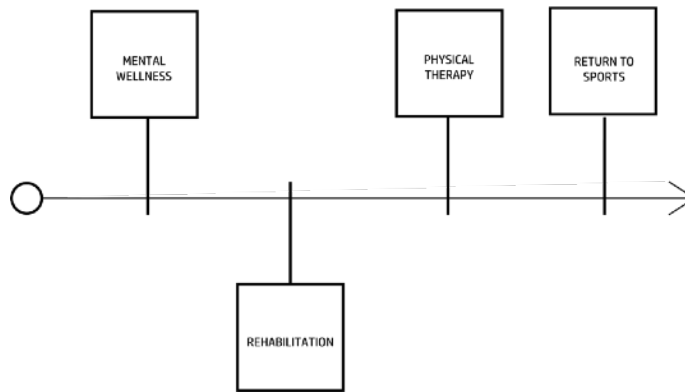

4

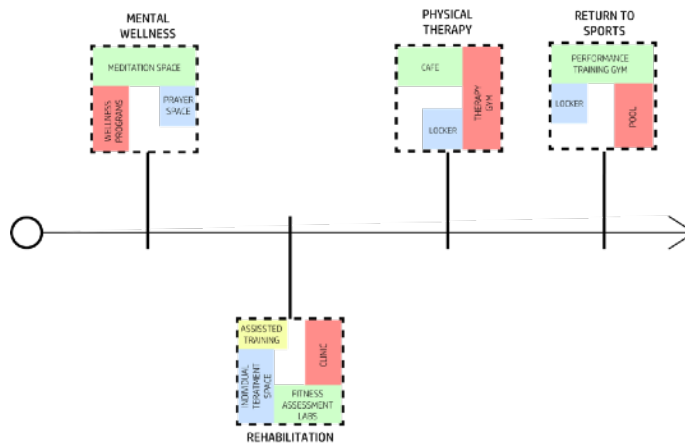

RECOVERY MAP

Typical Timeline of Phases of Rehabilitation

GRID SYSTEM



WOOD BOARDS

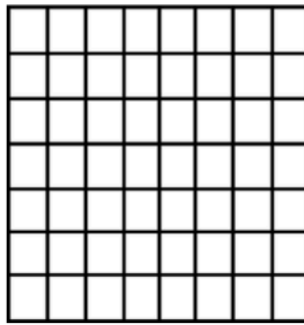

Using the 8x7 grid system used in Adire textiles as a reference, we can construct a similar grid using lumber. Scale can vary.

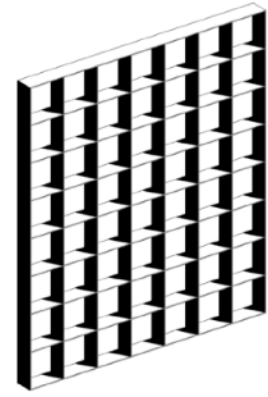

Constructed grid system

PANEL PATTERN



CORRUGATED STEEL SHEETS*



CLEAR CORRUGATED PVC SHEETS

*Steel sheets were selected to represent the traditional Yoruba deity of warriors, Ogun. Steel is the primary emblem of Ogun.

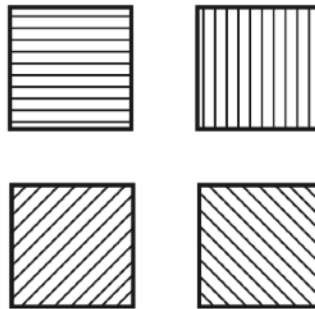

Using both the opaque and clear corrugated sheets cut in squares in four different directions, we have 8 panel options that could be placed onto the grid system.

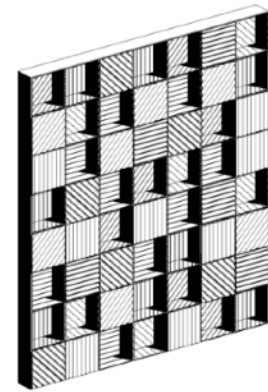

Fully constructed panel system

ARCHITECTURAL APPLICATIONS

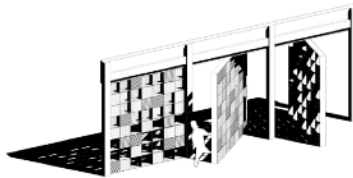

PIVOT DOORS

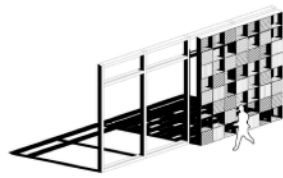

SCREEN FACADE



PAVILION SHADE

TEXTILE ART ARCHITYPEOLOGY

Pattern + Grid + Texture + Connectivity



AERIAL VIEW

Layout of Harmony and Rejuvenation





ENTRY

The Entry Experience





BREATHE CLEAN

Reassuring Messages





REVITALIZE

Inclusive Parking and Grand Administrative Hall





RESTORING HOPE

Careful landscaping invoking the Senses





NEW PURPOSE

Finding new purpose through sporting activities





FAMILY SUPPORT

For the Love of Family

1. Entrance and Parking

A welcoming entrance (1) and ample parking space ensure easy access for visitors, staff, and residents.

A dedicated drop-off area (5) facilitates smooth and efficient arrival and departure.

2. Healthcare and Administrative Facilities

The administration and clinic (6) provide centralized services for both medical and administrative needs. The Mental Wellness, Prayer, & Meditation Block (9) offers spaces for spiritual and mental healing, catering to diverse needs.

3. Residential Areas:

Family housing units (7) and residential apartments

(9) provide comfortable living spaces for families and individuals.

Separate male (15) and female (14) wards ensure privacy and tailored care for all residents.

Staff accommodations (20) are conveniently located to ensure immediate support and care.

4. Recreational and Fitness Facilities:

The state-of-the-art track and field complex (21) forms the center-piece of the site, symbolizing empowerment and personal achievement. Additional sports facilities, including tennis (23) and volleyball (24) courts, and a basketball court (12), provide diverse physical activity options.

An indoor/outdoor gym (16) and swimming pool

(17) cater to a wide range of fitness and therapeutic needs.

5. Healing and Reflection Spaces:

The Hope Garden (4), Healing Walkway Spine (18), and Healing Gardens (19) offer serene environments for reflection and relaxation.

The Peace Garden (31) and Peace Farm (28) provide therapeutic agricultural experiences and a source of fresh produce. The Pond Viewing Platform (11) and Children's Play Area (8) create inclusive spaces for all ages.

6. Community and Social Spaces:

An amphitheater (30) and theatre space (30) are

designed for events, performances, and communal gatherings. The Riverwalk Pavilion (27) and Lily pads (32) along the river stream offer scenic walkways and areas for meditation and relaxation. Also included is a multi faith place of worship, a mosque and community retail and commercial area.

7. Support Facilities:

The storage and vehicle maintenance area (2) ensures the smooth operation of the facility. Farm storage and maintenance facilities (29) support the agricultural aspects of the center.

The Track Pavilion (22) and Cheering Platform (25) enhance the experience of participants and spectators alike.



WEIGHTLESS

Transformative Scenes





SPORTS HEALS

Reinventing oneself through sports





CALM AS A STREAM

Improving the Microclimate





NURTURING

Activities to encourage community building

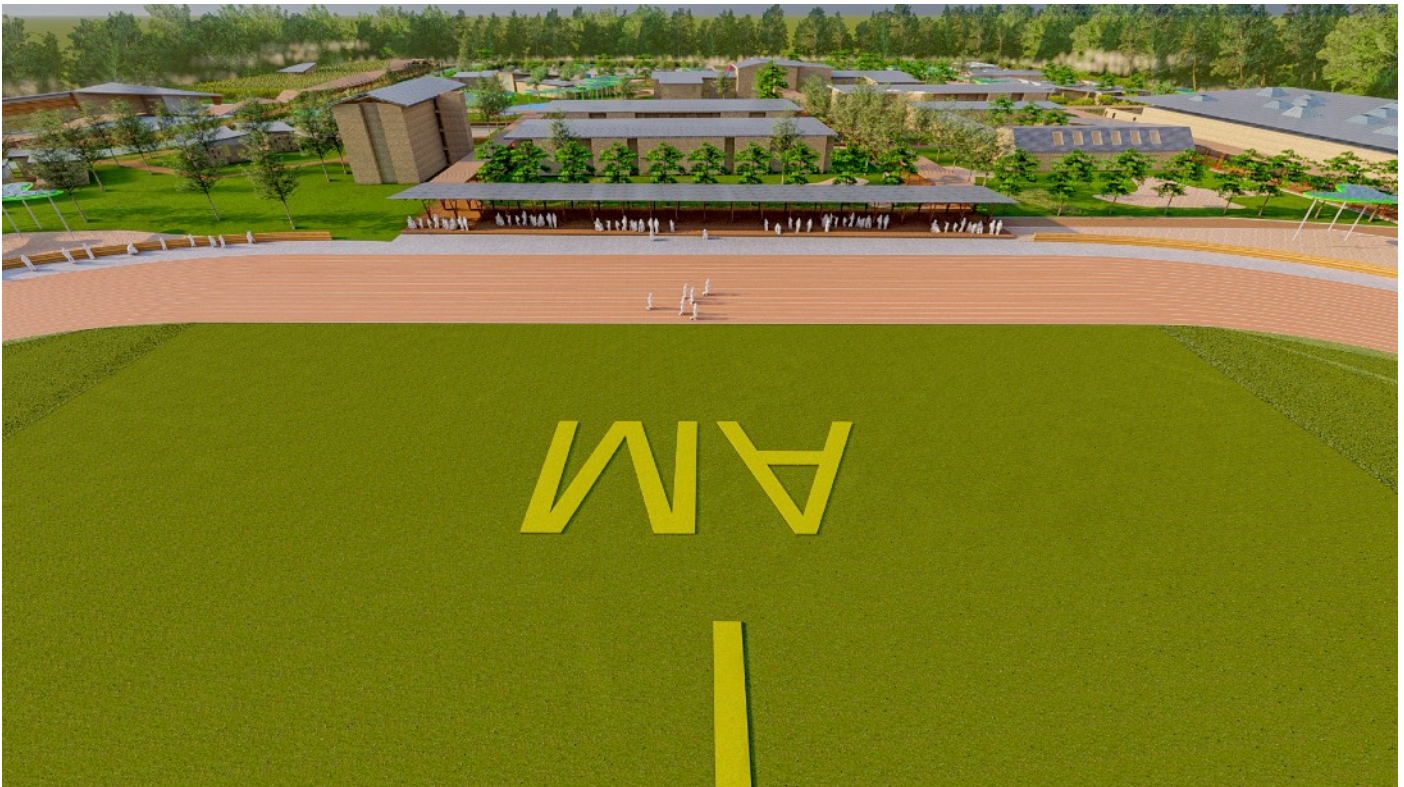



REALISTIC RENDERS

Administration/Clinic and Entry Walkway Pavilion





REALISTIC RENDERS

Entry Walkway Pavilion and Male Ward





REALISTIC RENDERS

Family Housing and Staff Accommodation





REALISTIC RENDERS

Theatre, Mental Wellness, Prayer and Meditation



THE **INVICTUS CENTRE** IN GIRI, ABUJA, STANDS AS A PIONEERING INSTITUTION DEDICATED TO THE COMPREHENSIVE CARE OF **WIS SOLDIERS**. ITS THOUGHTFUL DESIGN, INSPIRED BY NIGERIAN ARCHITECTURAL HERITAGE AND THE GARDEN CITY CONCEPT, CREATES A NURTURING AND EMPOWERING ENVIRONMENT. HERE, WITHIN THE TRANQUIL EMBRACE OF **NATURE** AND **COMMUNITY**, SOLDIERS ARE GIVEN THE OPPORTUNITY TO **HEAL, HOPE, AND RENEW**, EMBARKING ON A TRANSFORMATIVE JOURNEY THAT HONOURS THEIR SERVICE AND SUPPORTS THEIR REINTEGRATION INTO **SOCIETY**.

THANK YOU

